

R31SL SERIES

High Purity Low Flow Regulator

Specialty Gas Equipment



GENTEC® R31SL Series Stainless Steel Regulator is a Diaphragm-Sensed Dual-Stage High Purity Regulator designed for applications where a consistent outlet pressure and flow are desired.

Product Features

- Dual-Stage Configuration
- Metal-to-Metal Seal
- Body Port Size: 1/4" NPT(F)
- 2" Pressure Gauge

▶ R31SLMK-DIK-C350-11-D

Materials

- | | |
|------------------|----------------------|
| • Body | 316 Stainless Steel |
| • Bonnet | 316L Stainless Steel |
| • Seat | PCTFE |
| • Diaphragm | 316L Stainless Steel |
| • Adjusting Knob | ABS Plastic |

Applications

- Research Laboratories
- Gas Chromatography
- Process Analyzers
- Petrochemical Industry
- Power Plants

Specifications

- Maximum inlet pressure: 3000 psig
- Maximum outlet pressure: 250 psig
- Safety test pressure: 1.5 x Maximum inlet pressure
- Temperature range: -40°F~165°F (-40°C~ 74°C)
- Inboard leakage: 2×10^{-8} atm.cc/sec He
- Outboard leakage: 2×10^{-8} atm.cc/sec He inlet pressure: 1500 psig
- Maximum Cv: 0.08
- Weight: 4.03 lb

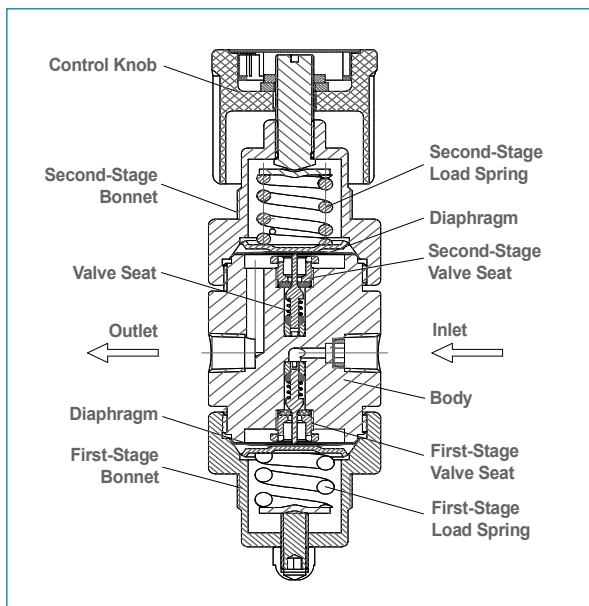

Dimensions

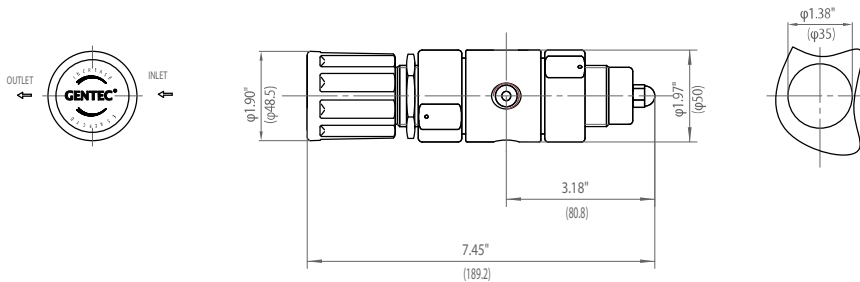

Front Panel Mount
Max. Thickness: 1/4" (7mm)

Flow Data

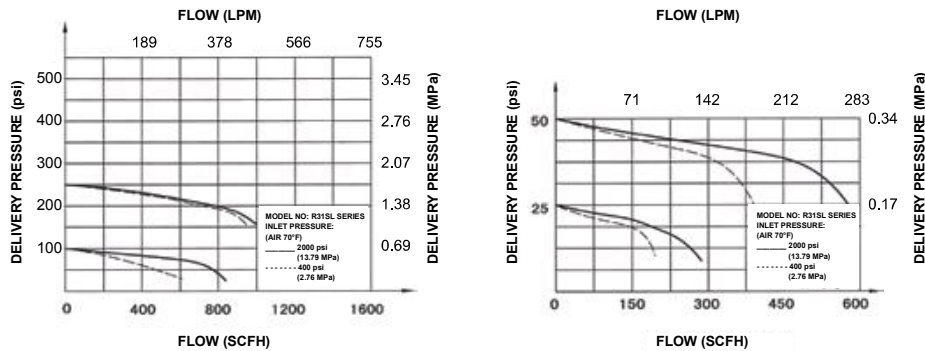

Body Ports

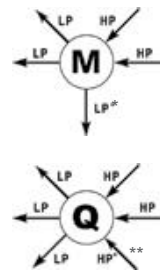

** For R31 Series, this high pressure "Q" port configuration is plugged. This port can be used for purging purpose only.

* For the "M" port configuration of R31 Series, this port is plugged and cannot be used for relief valve installation.

Ordering Information

EX:R31SL	M	K -	D	I	K -	C350 -	11 -	D
Series	Body Ports	Seat	Inlet Pressure Range	Outlet Pressure Ranges	Gauge	Inlet Connections	Outlet Connections	Options
• R31SL	M Q	K: PCTFE	D: 3000 psig	G: 0-250 psig I: 0-100 psig K: 0-50 psig L: 0-25 psig Q: 30" Hg Vac-30 psig S: 30" Hg Vac-100 psig T: 30" Hg Vac-200 psig	K: psig/kPa P: psig/bar W: No Gauge	00: 1/4" NPT(F) C330: CGA330 C350: CGA350 C580: CGA580 C660: CGA660 C590: CGA590 Other connections available	00: 1/4" NPT(F) 01: 1/4" NPT(M) 10: 1/8" GENLOK 11: 1/4" GENLOK 14B: 1/4" Hose Barb Other connections available	Blank: None D: Diaphragm Valve N: Needle Valve P: Panel Mount R: Relief Valve