

# R31B SERIES

High Purity Low Flow Regulator

Specialty Gas Equipment



GENTEC® R31B Series Brass Regulator is a Diaphragm-Sensed Dual-Stage High Purity Regulator designed for analytical applications where a consistent outlet pressure and flow are desired.

## Product Features

- Dual-Stage Configuration
- Metal-to-Metal Seal
- Body Port Size: 1/4" NPT(F)
- 2" Pressure Gauge

## ▶ R31BMK-DIK-C350-11-D

### Materials

- |                  |                              |
|------------------|------------------------------|
| • Body           | Nickel-Plated Brass Barstock |
| • Bonnet         | Nickel-Plated Brass Barstock |
| • Seat           | PCTFE                        |
| • Diaphragm      | 316L                         |
| • Adjusting Knob | ABS Plastic                  |

## Applications

- Cylinders
- Research Laboratories
- Gas Chromatography
- Process Analyzers
- Petrochemical Industry
- Power Plant

## Specifications

- Maximum inlet pressure: 3000 psig
- Maximum outlet pressure: 250 psig
- Safety test pressure: 1.5 x Maximum inlet pressure
- Temperature range: -40°F~165°F (-40°C~ 74°C)
- Inboard leakage:  $2 \times 10^{-8}$  atm.cc/sec He
- Outboard leakage:  $2 \times 10^{-8}$  atm.cc/sec He
- Maximum Cv: 0.08
- Weight: 4.03 lb

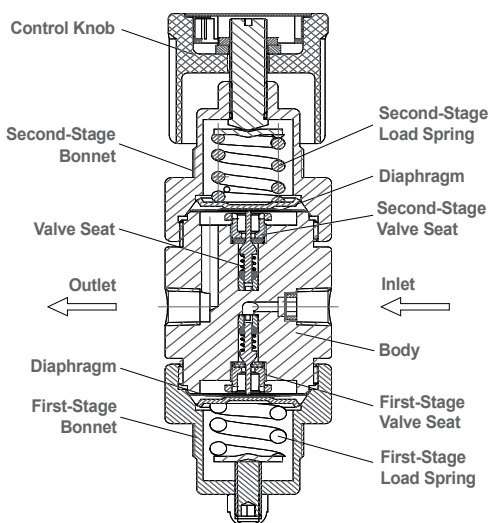

**Dimensions**

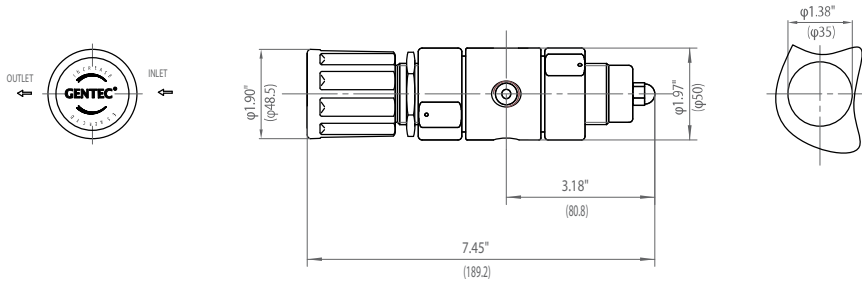

Front Panel Mount  
Max. Thickness: 1/4" (7mm)

**Flow Data**

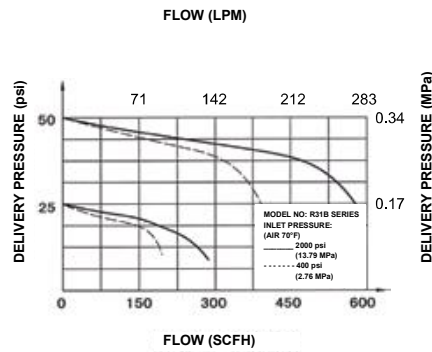
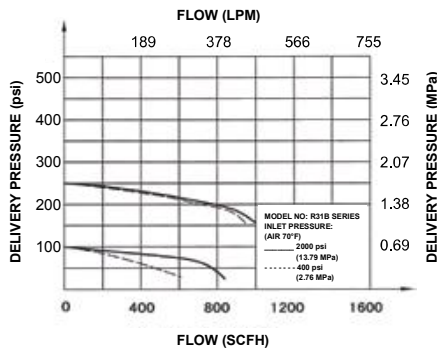

**Body Ports**

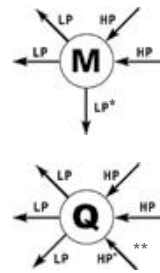

\*\* For R31 Series, this high pressure "Q" port configuration is plugged. This port can be used for purging purpose only.

\* For the "M" port configuration of R31 Series, this port is plugged and cannot be used for relief valve installation.

**Ordering Information**

EX:R31B	M	K -	D	I	K -	C350 -	11 -	D
Series	Body Ports	Seat	Inlet Pressure Range	Outlet Pressure Ranges	Gauge	Inlet Connections	Outlet Connections	Options
• R31B	M Q	K: PCTFE	D: 3000 psig	G: 0-250 psig I: 0-100 psig K: 0-50 psig L: 0-25 psig Q: 30" Hg Vac-30 psig S: 30" Hg Vac-100 psig T: 30" Hg Vac-200 psig	K: psig/kPa P: psig/bar W: No Gauge	00: 1/4" NPT(F) C346: CGA346 C320: CGA320 C350: CGA350 C510: CGA510 C540: CGA540 C580: CGA580 C590: CGA590 C326: CGA326 Other connections available	00: 1/4" NPT(F) 01: 1/8" NPT(M) 10: 1/8" GENLOK 11: 1/4" GENLOK 12: 3/8" GENLOK 14B: 1/4" Hose Barb Other connections available	Blank: None D: Diaphragm Valve N: Needle Valve P: Panel Mount R: Relief Valve